

# 樹脂開閉器

## PARTING LOCKS

塑膠  
模用  
配件

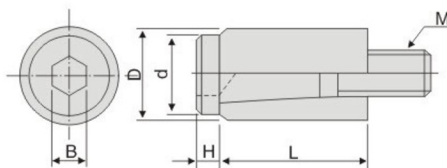

Catalog No.		d	H	L	M	B	Price 單價 RMB
Type	D						
JH060	10	8.5	3	18	M5	4	
	12	11	3.5	20	m6	5	
	13	11	3.5	20	m6	5	20
	16	14	4	25	m8	6	24
	20	16	5	30	m10	8	28

### 《樹脂開閉器》特性說明:

1. 由斜度螺絲調整模板與樹脂間之摩擦力，約轉1/4圈可合閉模具約5萬次。
  2. 模具裝置拆卸容易、簡單，價格低。
  3. 此裝置也可用在小水口板與打中板或二段頂出小水口或滑座之工件上。
  4. 模具重量100kg以下用12Φ-4個，500kg以下用16Φ-4個，1000Kg以下用20Φ-4個，若超過1000kg以上，則增加為6個以上。
  5. 樹脂埋入公模板約3公分，母模之孔以H7之絞刀加工至+0.1mm範圍內內面加工至□□□-□□□□
  6. 母模面請加工成R狀。如做C面之倒角，耐久性較差。
  7. 請勿在樹脂上加油，因為加油會使摩擦力減低。
- 分：白 黃 橘三色 Division:white,yellow,orange three cdors.

### Features:

1. Use sloping screw to adjust mold plate and parting locks, then turn 90 degrees parting locks can be closed upto 50,000 times.
2. Easy to assemble and disassemble, and cost efficient.
3. Can also be installed into small, medium size, and 2-sectional injecting metal pipes, or can be installed on sliding bases.
4. Mold weight 100kg, using 4pcs of 12Φ. Mold weight 500kg, using 4pcs of 16Φ. Mold weight 1000kg, using 4pcs of 20Φ.  
Mold weight 1000kg, using at least 6pcs.
5. Insert parting locks into die mold about 3cm, the using H7 reamer to process mold hole within +0.1mm range.
6. Process mold surface to the shape of letter "R", if processing to the chamfering of letter "C" it will shorten its life cycle.
7. Donot add any oil on paring locks. doing so will reduce the friction.

Order: Catalog No. [D] x [L]