

石墨分布区  
S: Graphite embedded area

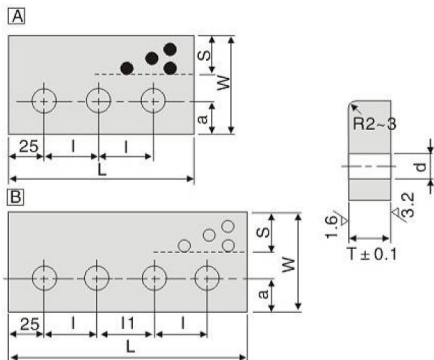

材質	高力黃銅+石墨
Material	650#+Graphite
材質	FC250鑄鐵+石墨
Material	250#+Graphite

無給油零件  
Oil free components

Catalog No.		L	W	I	I1	a	S	d	Sketch 圖示	
Type	T									
JH117	20	150	52	50	-	20	12	13	A	
		200		75	-				B	
		250		50	-				B	
	30	150	72	50	-	25	22	18	A	
		200		75	-				B	
		250		50	-				B	
	35	150	77	50	-	25	27	18	A	
		200		75	-				B	
		250		50	-				B	
	40	150	82	50	-	25	32	18	A	
				200	75				-	B
				250	50				-	A
200		105	50	-	25	32	18	B		
			75	50				-	A	
			50	-				-	B	
JH117-1	20	150	52	50	-	20	12	13	A	
		200		75	-				B	
		250		50	-				B	
	30	150	72	50	-	25	22	18	A	
		200		75	-				B	
		250		50	-				B	
	35	150	77	50	-	25	27	18	A	
		200		75	-				B	
		250		50	-				B	
	40	150	82	50	-	25	32	18	A	
				200	75				-	B
				250	50				-	A
200		105	50	-	25	32	18	B		
			75	50				-	A	
			50	-				-	B	

●Order: Catalog No.  $\boxed{T} \times \boxed{L} \times \boxed{L}$