

含附件LF

採用彈簧鋼製造，主要利用底部釋放彈性，含導套配合，防止與模板之間長期摩擦而損壞。  
It's made from spring steel, release elasticity at bottom, with guide bushing to prevent the damage from long time's friction between it and mold plate.

| Material<br>M 材質 | Hardness<br>硬度 |
|------------------|----------------|
| 1.8159           | HRC45° ±3°     |

| Type    | 尺寸/dimension |      |      |     |    |      |      |         |      |
|---------|--------------|------|------|-----|----|------|------|---------|------|
|         | A            | B    | D    | E   | F  | LFΦG | P    | T       | Z    |
| JHN02-1 | 6            | 6.2  | 10   | 3.5 | 50 | 12   | 13.5 | M4 × 12 | 3.5  |
| JHN02-2 |              | 8.2  |      |     |    |      |      |         | 6.5  |
| JHN02-3 | 8            | 10.2 | 11.2 | 4.5 | 65 | 16   | 14.5 | M5 × 12 | 7.5  |
| JHN02-4 |              | 12.2 |      |     |    |      |      |         | 9.5  |
| JHN02-5 | 10           | 15.2 | 13.6 | 5.5 | 80 | 16   | 15.5 | M6 × 12 | 12.5 |
| JHN02-6 |              | 18.2 |      |     |    |      |      |         | 15.5 |

### 固定栓 Locating pin

裝在頂出板上以固定彈弓頂針使其保持在合適的位置上。固定栓保持力超出7.5N。  
Ins talled on ejector plate to fix the sling ejector pin, to keep it in suitable location, The hold force of locating pin above 7.5N.

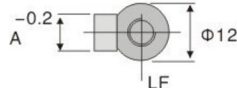
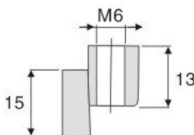
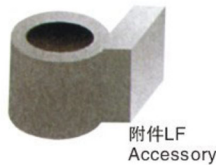

### 使用例 Example

